

# Oticon Medical Streamer XM Instructions for Use



Made for  
Apple iPhone | iPad | iPod



oticon  
MEDICAL

## **Introduction to this booklet**

This booklet guides you on how to use and maintain your new Streamer. Please read the booklet carefully, including the Warning section. This will help you achieve the full benefit of your new Streamer.

If you have additional questions about the use of your Streamer, please contact your hearing care professional.

The Streamer connects your hearing aids wirelessly to different audio sources and makes your hearing aids work like wireless headphones. The Streamer transmits the sound directly into both hearing aids and thereby improves the audio experience.

## Intended use

Oticon Medical Streamer XM is intended to be used by wireless hearing solutions users. The product is intended to be used together with the given hearing solution. The Streamer is a communication interface between the hearing solutions and other devices such as cell phones. The Streamer can be connected to a range of external (additional) devices to enable the hearing instrument user to better hear a TV or to communicate through Bluetooth-enabled cell phones, etc.

The Streamer can also be used as a remote control that enables you to adjust the hearing instrument volume and change programs in the hearing instruments.

The Streamer is not intended to be used by infants/children < 36 months.

“Made for iPod,” “Made for iPhone,” and “Made for iPad” mean that an electronic accessory has been designed to connect specifically to iPod, iPhone, or iPad, respectively, and has been certified by the developer to meet Apple performance standards. Apple is not responsible for the operation of this device or its compliance with safety and regulatory standards. Please note that the use of this accessory with iPod, iPhone, or iPad may affect wireless performance.

Apple, the Apple logo, iPhone, iPad, and iPod touch are trademarks of Apple Inc., registered in the U.S. and other countries. App Store is a service mark of Apple Inc. Android, Google Play, and the Google Play logo are trademarks of Google LLC. The Android robot is reproduced or modified from work created and shared by Google and used according to terms described in the Creative Commons 3.0 Attribution License.

# Contents

Package content	8
Streamer overview	11
<b>Basic functions – first-time use</b>	
Wearing the Streamer with the neck loop	12
Using the Streamer without the neck loop	14
Turning the Streamer on and off	16
Static electricity	18
Charging the Streamer	20
Battery low indicator	22
Remote control of the hearing aids	26
Pairing the Streamer with a mobile phone and other devices	28
Clear pairing	30

Continues on next page

## Primary functions

Connectivity/streaming	32
Mobile phone	33
ConnectLine Phone solution	40
ConnectLine microphone	42
ConnectLine TV solution	44

## Secondary functions

ConnectLine App	46
Connectivity/streaming	47
Music/audio cable	48
Headset cable	50
Music/audio wireless	52
PC headset – wireless	54
T-coil (built-in)	56
FM receiver (optional)	58

Additional information	
Cleaning and maintenance	61
Accessories and spare parts	62
Warnings	64
Technical information	68
International warranty	72

## Package content

The Streamer box consists of the following elements:



Streamer



Neck loop – medium (page 12)



Neck loop – long (page 12)

Box 1



Charger (page 20)

Box 3



Protective skin (page 62)

*Power supply will vary from country to country.*



Box 2

USB charger cable  
(page 20)



3.5 mm mini jack  
stereo cable  
for MP3/music  
(page 48)

3.5 mm headset  
splitter cable for use  
with PCs (page 50)



## This guide (Instructions for use)

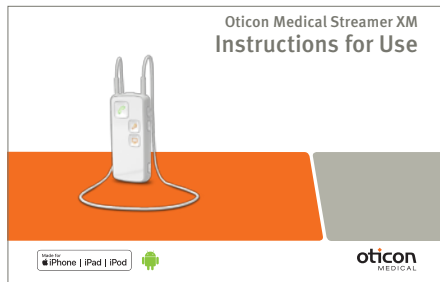

### **IMPORTANT NOTICE**

Please refer to your hearing aid's Instructions for Use for details on the functionality of your specific hearing aid solution.

# Streamer overview

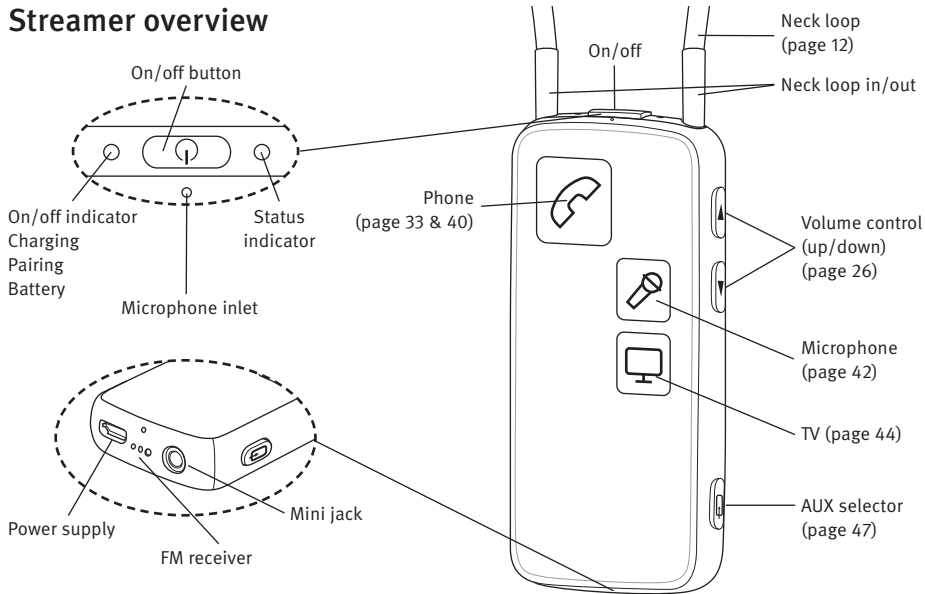

## Basic functions – first-time use

### Wearing the Streamer with the neck loop

The neck loop is an integral part of the Streamer's electronic system. It is used as an antenna to transmit sound to your hearing aids.

For the best possible sound and longest possible streaming time, the Streamer should always be worn with one of the included neck loops. The Streamer comes with two neck loops, a long and a medium.

#### **IMPORTANT NOTICE**

Please use the neck loop carefully. To avoid strangulation the neck loop will automatically release if it gets caught in something. Do not shorten or modify the neck loop in any way, such as tie a knot to shorten the length. If a neck loop breaks, it cannot be repaired and must be replaced immediately. Consult your hearing care professional for a replacement.

## Inserting neck loop

The neck loop snaps into the holes on the top of the Streamer.

*Note that when talking to somebody through the Streamer, it is important that your voice can be picked up by the built-in microphone on the top.*

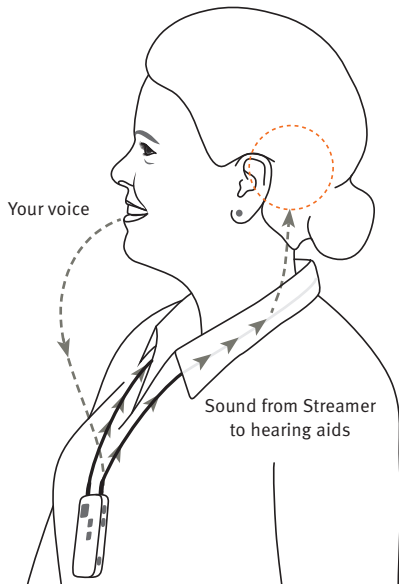
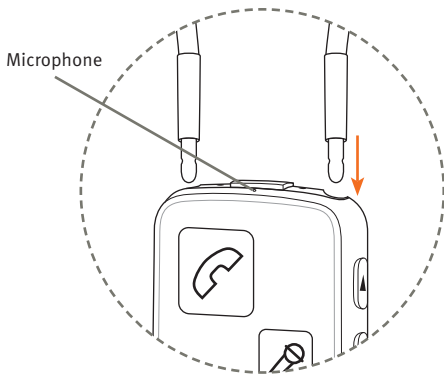

## Using the Streamer without the neck loop

Depending on the hearing aid, the Streamer can also be used without the neck loop, e.g. with the optional belt clip. The distance to the hearing aid should then be less than one meter. You may experience dropouts in sound, which is why we recommend using the neck loop. If the Streamer is used without the neck loop, then the Streamer functionalities depend upon whether the Streamer is in open mode (the default) or your hearing care professional has set it to linked mode and paired it with your hearing aids, see the table below.

Functionality	Works in an open Streamer	Works in a linked Streamer
As a remote control	No	Yes
Hear the ring from an incoming call	Yes	Yes
Streaming of sound from e.g. TV, or phone calls	No	Yes

If the Streamer is used with the neck loop then it has all functionalities activated no matter whether the Streamer is open or linked.

When using the Streamer without the neck loop, more power will be used – consequently maximum streaming time is reduced to 5 hours on one full charge.

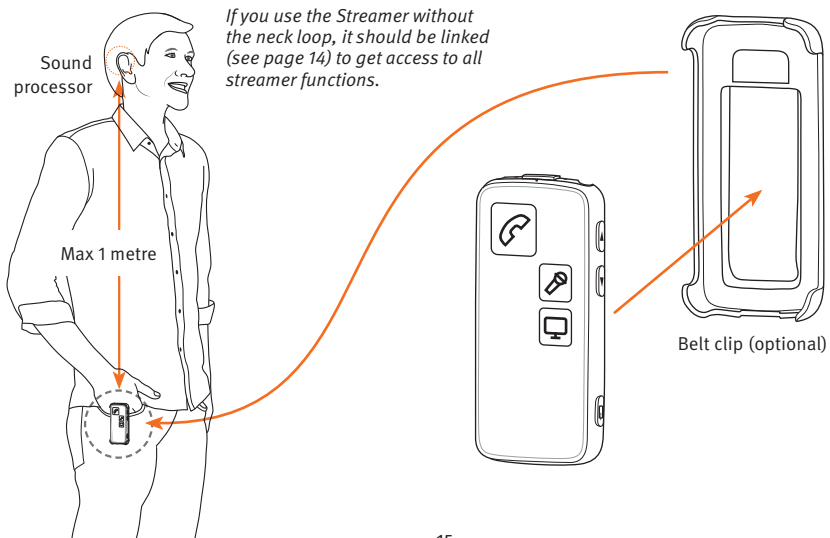

## Turning the Streamer on and off

### Power on

Press the **on/off button** on the top of the Streamer for approx. 2 seconds until all lights on the front and top flash to indicate it is powered on.

**Release the on/off button.** The power indicator on the top of the Streamer should now fade to green.

If the Streamer cannot power on, make sure it is charged (page 20).





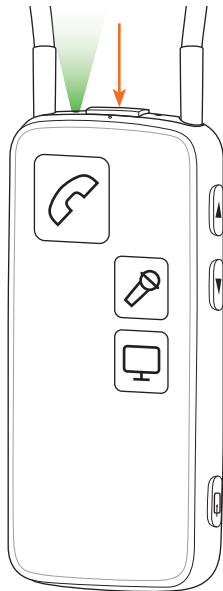

To see the status of the Streamer, press the on/off button briefly.

### Power off

Press and hold the on/off button on the top of the Streamer for approx. 2 seconds until the green on/off indicator is turned off.





Power on/off		
Status	Front	Description
		The Streamer is off
		After pressing the on/off button for approx. 2 seconds, all lights will be on for a few seconds to indicate that the Streamer is now turned on
		The Streamer is now turned on and ready for use

## Static electricity

If the streamer is exposed to electrostatic discharge, i.e. static electricity, it may stop streaming. The Streamer will by default restart and you can reactivate your streaming.

For detailed information on how to establish specific streaming connections, please refer to “Primary functions” (page 32) or “Secondary functions” (page 46) in this Instructions for use.



## Charging the Streamer

The Streamer uses a rechargeable battery. We recommend that you charge the Streamer once a day for best possible performance.

Insert cable from the enclosed charger in the micro USB socket in the bottom of the Streamer (A). Remember to connect the charger to a power outlet.



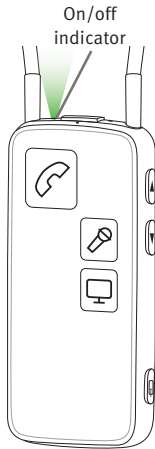

Charging, when turned on, is indicated by a blinking green indicator on the top. Once fully charged, the indicator will show steady green.

Charging, when turned off, is indicated by a blinking green indicator on the top. Once fully charged, the indicator will be off.



### IMPORTANT NOTICE



When recharging, the on/off indicator should be lit as described in this “Instructions for Use”. If the on/off is not lit, disconnect the Streamer from the charger and consult your hearing care professional.

Charging		
Status	Front	Description
 		Charging – when turned off – status indicator will blink green
 		Charging – when turned on (or in use) – the status indicator will shift between strong and soft green

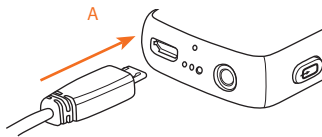
 Blink  Fade







### IMPORTANT NOTICE

When recharging the Streamer use the supplied original power supply 5.0V/1A, CE and safety marked.  

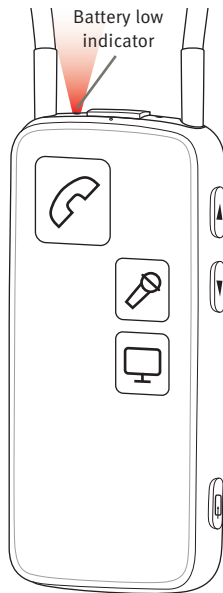
## Battery low indicator

The Streamer will indicate **battery low** (approx. 20 minutes capacity left) with a steady red light, and battery very low (approx. 5 minutes capacity left) with a blinking red light.



Battery low indicator		
Status	Front	Description
 		Battery low – approx. 20 minutes capacity left when streaming to hearing aids
 		Battery very low – approx. 5 minutes capacity left when streaming to hearing aids

 Steady  Fading

### IMPORTANT NOTICE

The battery should not be drained completely. Keeping the battery fully charged will prolong the capacity of the battery. The battery cannot be replaced by the user.

<b>Battery capacity and charge time</b>	
<b>Battery capacity using neck loop</b>	Up to 10 hours typical daily use: 2 hours phone, 6 hours TV and 2 hours standby.
<b>Battery capacity not using neck loop</b>	Up to 5 hours typical use: 1 hour phone, 3 hours TV and 1 hour standby.
<b>Battery charge time</b>	2 hours for complete charge, using enclosed power supply.
<b>Remote control</b>	If the Streamer is turned off, remote control of hearing aid will work for up to 6 months on one full charge.
<b>Battery life expectancy</b>	The battery in the Streamer will last for more than 2 years if fully charged once a day. The battery can be replaced by your hearing care professional.





## Remote control of the hearing aids

### Volume up/down

Briefly pressing on either volume up or down will regulate the volume in the hearing aids accordingly. You will hear confirmation sounds in the hearing aids.

### Changing programmes in the hearing aids

You can change programmes up or down by **holding the volume up or down** for more than one second. Changing programmes is indicated by a sound in your hearing aids.

### Muting the hearing aids

You can mute the hearing aids by **pressing the volume up AND down for 1 second simultaneously**.

### IMPORTANT NOTICE

Even though the Streamer is turned off, the remote functionality of the hearing aids will still work.

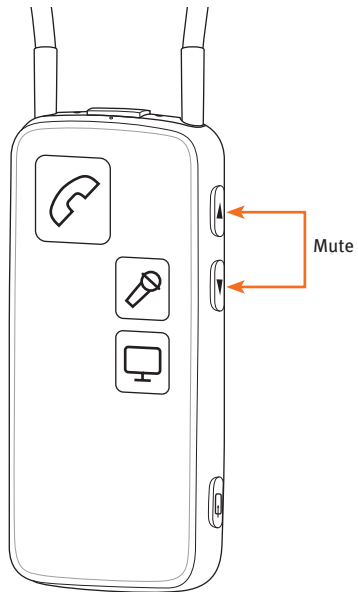
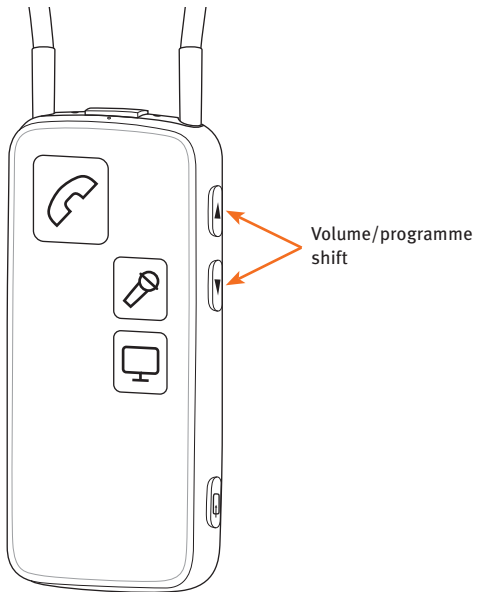

## Pairing the Streamer with a mobile phone and other devices

Before the Streamer can be used with other devices – such as mobile phones – the two devices have to be paired.

1. Put the Streamer in pairing mode

Press and hold the on/off button for approx. 5 seconds, until the indicator blinks blue.

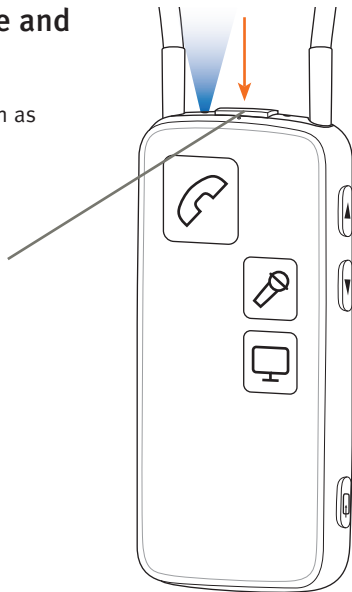

- Put the other device (e.g. mobile) in pairing mode.

This is typically in a set-up menu on your phone.  
We advise you to look in your mobile phone's Instructions for Use, e.g. under pairing.

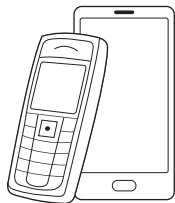

- The other device (mobile phone) will often request a pin code.

The pin code for the Streamer is 0000 (four zeros).

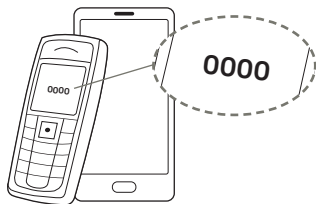



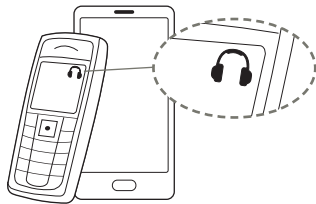





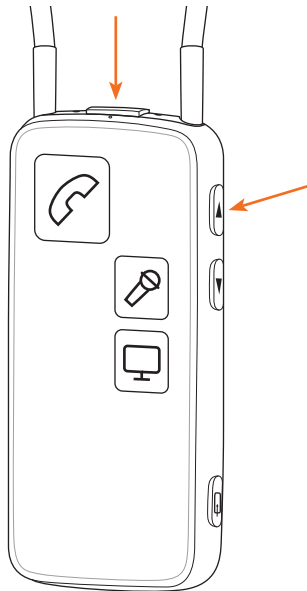

- Once paired, the mobile phone will typically show a headset icon; at the same time the Streamer pairing indicator will be steady blue.



## Clear pairing

If you have problems with pairings, you can clear all pairings by pressing the on/off button and the volume up button at the same time for 3 seconds.



Pairing		
Status	Front	Description
  		Streamer in pairing mode
  		Pairing complete
  		Streamer on

 Steady  Blinking

## Primary functions

### Connectivity/streaming

The Streamer user interface has been designed to give you the best possible daily use in the following situations:

1. Use of a mobile phone through Bluetooth\* (page 33).

Use of the ConnectLine Phone solution (sold separately) with an analogue landline phone\* (page 40).

2. Use of a ConnectLine microphone (sold separately), to improve your chances of hearing a chosen speaker at a distance, or in very noisy situations (page 42).

3. Use of ConnectLine TV solution (sold separately) to wirelessly transmit the TV sound to your hearing aids\* (page 44).

\* In effect turning the Streamer and the hearing aids into a wireless headset

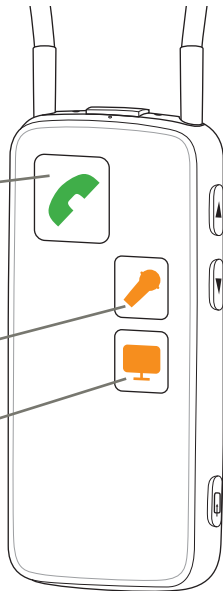



## Mobile phone

To be able to receive or make calls while using the Streamer, make sure that the Streamer and mobile phone have been paired (pages 28-31), are turned on and are within range (10 metres). Your mobile phone may indicate that it is connected to the Streamer with a small headset icon.

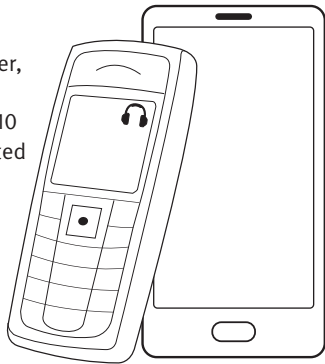

### How to answer a call





Make sure that you are able to speak into the Streamer's microphone.

When your mobile phone rings, you will hear an incoming call alert in your hearing aids. At the same time the phone button on the Streamer and the status indicator will blink green.

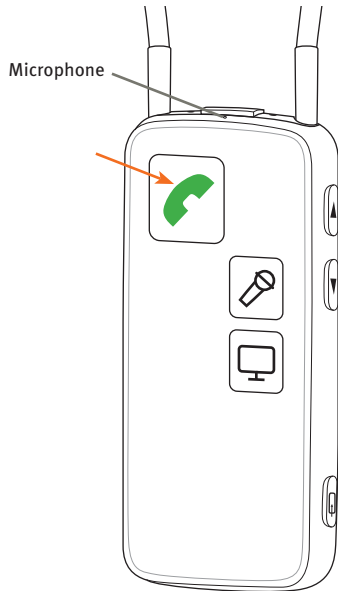
Press the phone button on the Streamer briefly to answer the call. You will hear a confirmation sound in your hearing aids. The phone button and status indicator will now be steady green.

To end the call, simply press the phone button on the Streamer briefly.



Receiving a call		
Status	Front	Description
		Streamer on and ready
		Phone indicator and top status blinks green. You will hear an incoming call indicator in your hearing aids
		When the call is connected, you will hear a sound acknowledging that the call is answered – you are now able to listen and talk to the other party

 Steady  Blinking

## How to make a call



Make sure that you are able to speak into the Streamer's microphone.

To make a call, you only need to operate the mobile phone. You do not need to operate the Streamer. Simply **key in the number as you normally do to make a call** – the call is automatically connected to your Streamer.

The phone button on the Streamer and the status indicator on the top will turn green, and you will hear a confirmation sound in your hearing aids indicating that the call is now connected through your Streamer and hearing aids.

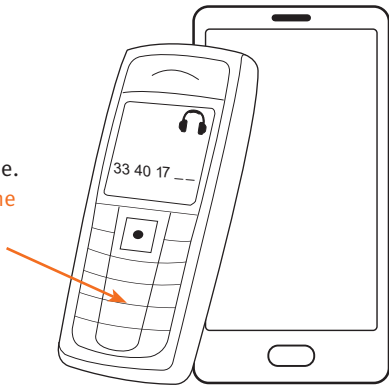
To end the call, simply press the “call end” button on the phone or the phone button on the Streamer briefly.



Making a call		
Status	Front	Description
		Streamer on and ready
		When the call is connected, you will hear a sound acknowledging that the call is connected – you are able to listen and talk to the other party

 Steady

## **Personalisation of mobile phone features**

The following mobile phone features can be enabled, or disabled, by your hearing care professional.

### Reject call – default on

An incoming call can be rejected by briefly pressing the volume down button on the Streamer.

### Voice dial – default on

Briefly pressing the phone button will enable voice dial (if supported by your mobile phone and you are not in range of a ConnectLine Phone adapter).

Last number redial – default on

Pressing and holding the phone button will activate the last number redial (if supported by mobile phone).

Transfer call – default on

Pressing and holding the phone button will transfer a call back to the mobile phone.

All front buttons answer call – default on

If off, only the phone button on the Streamer will answer calls.

Enable incoming (A2DP) connections – default off

If enabled, other devices, e.g. iPods, computers and mobile phones can activate/start audio streaming, for example, incoming text alerts or music started from a paired and connected mobile phone.



## ConnectLine Phone solution

The Streamer can also be used with a traditional analogue landline phone by using a ConnectLine Phone solution, which is available as a separate accessory.

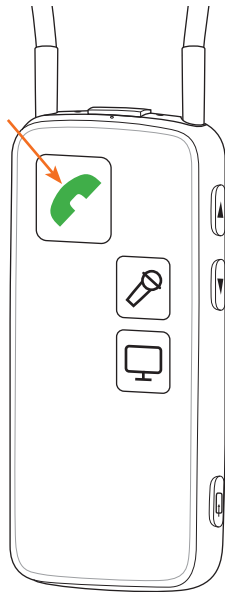
For details on how to use the ConnectLine Phone solution, please refer to the instructions included with the ConnectLine Phone solution.





Talking on the landline phone		
Status	Front	Description
		Streamer on and ready
		Streamer connected – you are able to listen and talk to the other party

 Steady

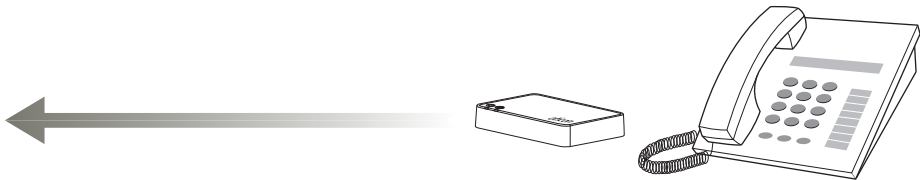



## ConnectLine microphone

As a separate accessory, a ConnectLine microphone is available. Speech from the person wearing the microphone is transferred through the streamer to the person wearing the hearing aid.

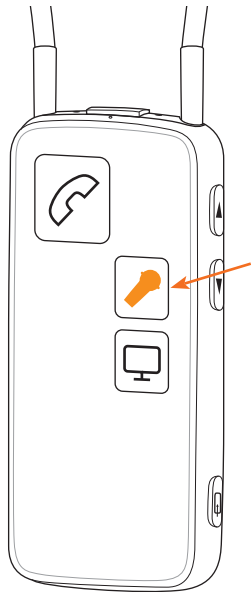
For details on how to use the ConnectLine microphone solution, please refer to the Instructions for Use included with the ConnectLine microphone.



Sound from ConnectLine microphone		
Status	Front	Description
		Streamer on and ready
		When connected to the microphone – you will hear sound from the microphone in your hearing aids

  Steady

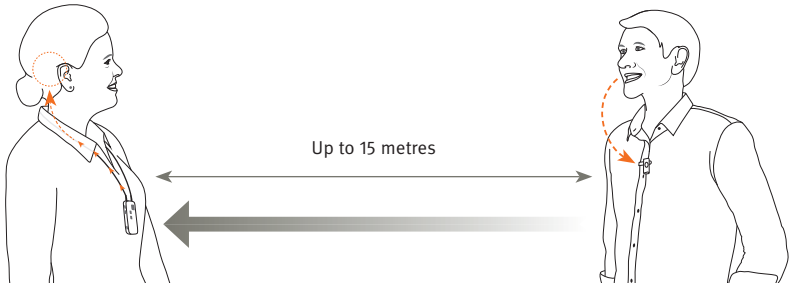

## ConnectLine TV solution

As a separate accessory, a ConnectLine TV solution is available, which transmits the sound from a TV to your hearing aids through the Streamer.

For details on how to use the ConnectLine TV solution, please refer to the Instructions for Use included with the ConnectLine TV solution.



Watching TV		
Status	Front	Description
		Streamer on and ready
		Connecting to TV
		Streamer connected – sound from TV in hearing aids

Steady Blinking

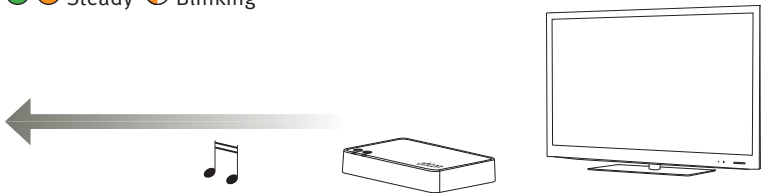

## Secondary functions

### ConnectLine App

The app for iPhone®, iPad®, iPod touch® and Android™ devices offers an intuitive and discreet way to control the hearing aids and the ConnectLine system. Also, it offers possibility to customise the features of the ConnectLine system.

Available on App Store® and on Google Play™.



Please visit [www.oticon.global/connectline](http://www.oticon.global/connectline) for more information and for details on compatibility.



## Connectivity/streaming

The Streamer can be used with a wide range of standard peripherals, such as MP3 players, computers, etc.

The following priorities apply.

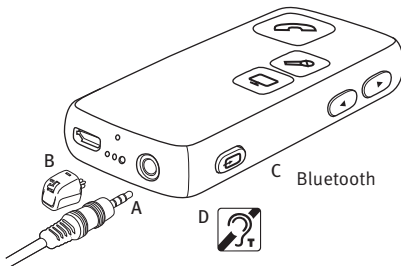

A	Priority 1	Mini jack in/out (if connected)	Briefly press AUX selector	Page 48
B	Priority 2	FM (if connected)	Briefly press AUX selector	Page 58
C	Priority 3	Wireless Bluetooth (built-in)	Briefly press AUX selector	Page 54
D	Priority 4	Tele loop receiver (built-in)	Press and hold AUX selector for approx. 2 seconds	Page 56

## Music/audio cable

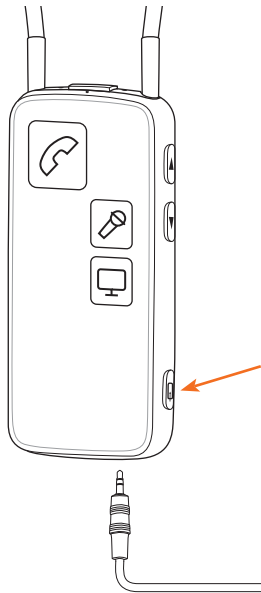

Inserting and connecting the included mini jack cable enables you to listen to music/audio from a wide range of devices.

To listen to audio from your device, simply press the **AUX selector briefly**. When the cable is inserted, streaming will start automatically.





## Music/audio – cable

Status	Front	Description
		Streamer on and ready
		You will hear a confirmation sound followed by the sound from the device

  Steady

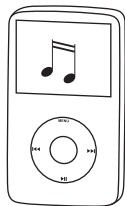



## Headset cable

Make sure that you are able to speak into the Streamer's microphone.

Inserting and connecting the included mini jack cable and the included headset splitter cable enables you to use the Streamer as a headset with your computer.

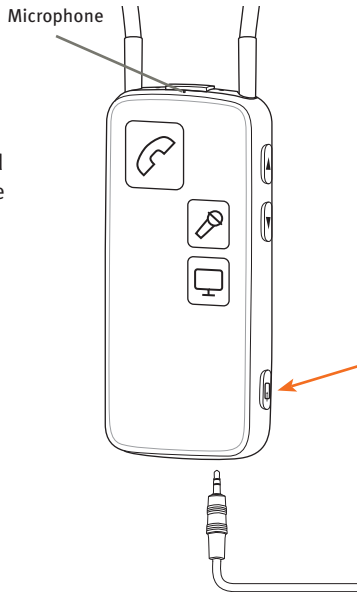
To use the headset function, simply **press the AUX selector briefly.**



Headset cable		
Status	Front	Description
		Streamer on and ready
		You will hear a confirmation sound – you are now able to listen and talk to the other party

  Steady

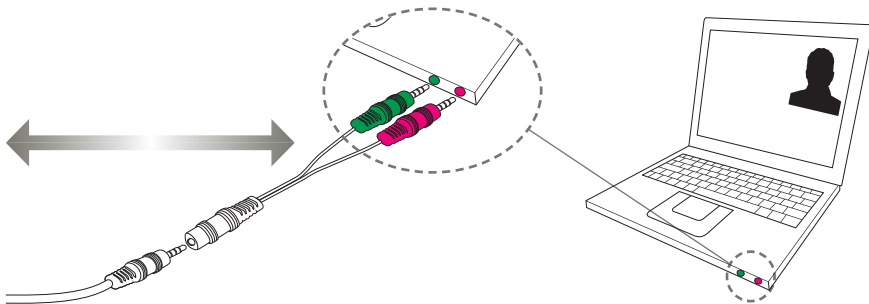

## Music/audio wireless



To hear music/sound wirelessly, e.g. from a mobile phone, tablet or computer with built-in Bluetooth, make sure that the device has been paired to your Streamer (page 28), that both are turned on, and within range (<10 metres).

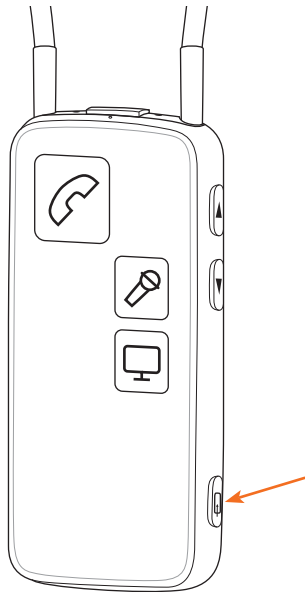

To listen to music e.g. from a mobile phone, press the AUX selector before starting the music player.

### Enable automatic connections – default off

If enabled by your hearing care professional, iPods, computers and mobile phones can automatically activate/start audio streaming, for example, incoming text alerts or music started from a paired and connected mobile phone.



Music/audio wireless		
Status	Front	Description
		Streamer on and ready
		Streamer connecting to music/audio device
		When connected, you will hear a confirmation sound followed by the sound from the device

  Steady  Blink







## PC headset – wireless

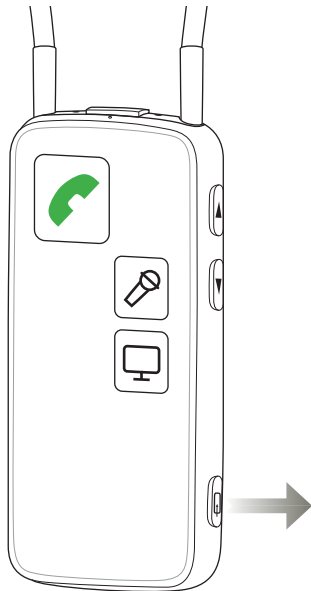

Make sure that you are able to speak into the Streamer's microphone inlet.

When pairing to a computer, make sure that the Streamer is paired as a headset device.

To use the headset function, call control is done from the computer.



Headset – wireless		
Status	Front	Description
		Streamer on and ready
		Streamer connecting to music/audio device
		When connected, you will hear a confirmation sound followed by the sound from the device

  Steady  Blink

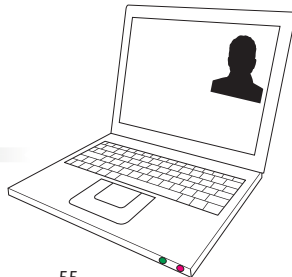

## T-coil (built-in)



The Streamer has a built-in tele loop receiver (T-coil).

To receive sound from the tele loop receiver, **press and hold the AUX selector for approx. 2 seconds.**

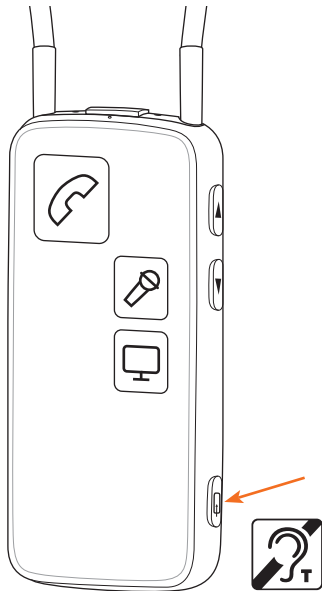
Please note: if desired, the operation can be changed so the T-coil can be activated by a brief press.





T-coil		
Status	Front	Description
		Streamer on and ready
		When connected, you will hear a confirmation sound followed by the sound from the tele loop system

  Steady



## FM receiver (optional)

An FM receiver can be plugged into the Euro pin socket. The receiver is used to receive FM signals from an FM transmitter, typically worn by a school teacher.

Simply plug in the FM receiver and briefly press the AUX selector. When the FM transmitter and receiver are synchronised and on the same channel, the FM signal will be received in the hearing aids.

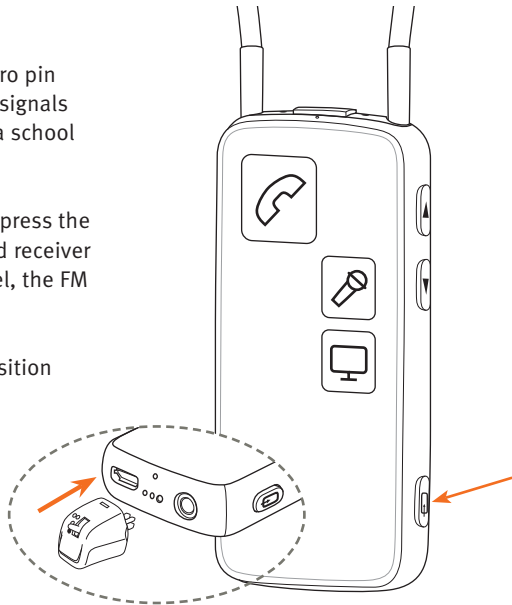
If your FM receiver has a toggle switch, position the switch onto the OO position.



FM		
Status	Front	Description
		Streamer on and ready. FM receiver powered on and ready for channel synchronisation
		When connected, you will hear a confirmation sound followed by the sound from the device

  Steady

### IMPORTANT NOTICE

Please ensure the Streamer is turned on, but not streaming sound to the hearing aids, when FM channel sync is required.



## Additional information

### Cleaning and maintenance

The Streamer is a sealed device that requires minimum maintenance. Any dirt, moisture or grease should be cleaned off by using a soft, dry cloth. It is recommended that you clean the Streamer on a regular basis. The microphone inlet and the connectors for audio input, neck loop and charging must be kept free of dirt or debris.

#### **IMPORTANT NOTICE**

Use a soft, dry cloth to clean the Streamer. The Streamer and the neck loop must never be washed or immersed in water or other liquids.

## Accessories and spare parts

### Protective skins

Additional protective skins, dark or light grey, are available from your hearing care professional.

### Protective skin – single button

A protective skin, dark or light grey, with one protruding button, which makes “blind” operation easier, is available from your hearing care professional.



### Replacement neck loops

Replacement neck loops, black or white, are available in up to three sizes (country dependent): Short (51 cm), medium (66 cm) and long (81 cm) from your hearing care professional.

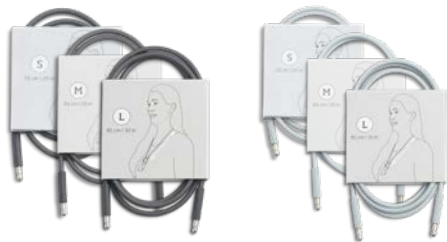

### Belt clip

A belt clip, black or white, is available from your hearing care professional.



## Warnings

You should familiarise yourself fully with the following general warnings and the entire contents of this booklet before using your Streamer to ensure personal safety and correct use. Consult your hearing care professional if you experience unexpected operations or events with your Streamer.

### **Connection to external equipment**

The safe use of the Streamer when connected to external equipment with an auxiliary input cable is determined by the external signal source. When connected to external equipment plugged into a wall outlet, this equipment must comply with IEC-62368 (or IEC-60065, IEC-60950 until June 20, 2019) or equivalent safety standards.

### **Rechargeable battery**

Do not attempt to open the Streamer, as it may damage the battery.

Never attempt to replace the battery. If battery replacement is needed, please return your device to the supplier. The service guarantee is void if there are signs of tampering.

The safety of recharging batteries using a USB connector is determined by the external power source. When connected to external equipment plugged into a wall outlet, this equipment must comply with IEC-62368 (or IEC-60065, IEC-60950 until June 20, 2019) or equivalent safety standards.

### **Choking hazards and risk of swallowing batteries or other small parts**

The Streamer, its parts and batteries should be kept out of reach of children and anyone who might swallow these items or otherwise cause injury to themselves.

*If a battery, hearing aid or small part is swallowed, see a doctor immediately.*



## Warnings

### **Cross control**

Your Streamer should be kept out of the reach of children or anyone who might take control of the functionality, to ensure your personal safety and avoid incorrect use.

### **Use of the Streamer with neck loop**

If by accident the neck loop is caught on something while wearing it, the neck loop is constructed to break automatically. Therefore, never try to shorten or modify the neck loop in an unauthorised way. The neck loop should not be used for children who weigh less than 11 kg.

### **Heat and chemicals**

The Streamer must never be exposed to extreme heat e.g. left inside a parked car in the sun. The Streamer must not be dried in microwave ovens or other ovens. The chemicals in cosmetics, hairspray, perfume, aftershave lotion, suntan lotion and insect repellent can damage the Streamer. Always remove your Streamer before applying such products and allow time to dry before use.

### **X-ray/CT/MR/PET scanning, electrotherapy and surgery**

Remove your Streamer before X-ray/CT/MR/PET scannings, electrotherapy, surgery, etc. as your Streamer may be damaged when exposed to strong electromagnetic fields.

### **Active implants**

Caution must be taken with active implants. In general, please follow the guidelines recommended by the manufacturers of implantable defibrillators and pacemakers on use with mobile phones and magnets as hearing aids and accessories also contain radio transmitters like mobile phones.

If you have an active brain implant, please contact the manufacturer of your implantable device for information about the risk of disturbance.

## Warnings

### **Possible side effects**

The otherwise non-allergenic materials used in your Streamer may in rare cases cause a skin irritation or other side effects.

Please seek consultation with a physician if these conditions occur.

### **Use in traffic**

Using the Streamer can distract you. Be aware of your surroundings while using the Streamer.

Please refer to national traffic laws regarding the use of communication devices while in traffic.

### **Use on aircraft**

Your Streamer contains Bluetooth. Your Streamer should not be used on board an aircraft, unless specifically permitted by the flight personnel.

### **Explosives**

The power source in your Streamer has insufficient energy to cause fire in normal usage conditions. The Streamer has not been tested for compliance with International standards concerning explosive environments. We recommend not to use your Streamer in areas where there is a danger of explosions.

### **Interference**

The Streamer has been thoroughly tested for interference according to the most stringent international standards. However, interference between the Streamer and other devices (e.g. some mobile telephones, citizens band devices, shop alarm systems and other wireless devices) may occur. If this occurs, increase the distance between the Streamer and the interfering device.

## Warnings

### **Mobile phone compatibility**

Please refer to [www.oticon.global/connectline](http://www.oticon.global/connectline) for a list of mobile phones that have been tested comprehensively by Oticon, and have been found to fulfil the minimum requirements for ConnectLine compatibility at the time of testing. However, Oticon takes no responsibility for such compatibility in general. Specifically, Oticon shall not be responsible for incompatibility resulting from future updates of the mobile phones, nor from events of incompatibility not covered by and/or found in these tests. Oticon takes no financial responsibility in terms of reimbursements of mobile phones that do not work as expected. Before purchasing a new mobile phone, you are advised to consult the list mentioned above.

## Technical information

<b>Product name</b>	Oticon Medical Streamer XM
<b>Product model</b>	Streamer Pro XM
<b>Conditions of use</b>	
<b>Operating conditions</b>	Temperature: +10°C to +45°C Humidity: <85% relative humidity Atmospheric pressure: 700 hPa to 1060 hPa
<b>Storage and transportation conditions</b>	Temperature and humidity shall not exceed the below limits for extended periods of time during transportation and storage: Temperature: -20 °C to +60 °C Humidity: <85% relative humidity Atmospheric pressure: 700 hPa to 1060 hPa

The Streamer contains a radio transceiver using short range magnetic induction technology working at 3.84 MHz. The magnetic field strength of the transmitter is very weak and always below 15 nW (typically below -15 dBuA/m at 10 metre distance).

The Streamer contains a radio transceiver using Bluetooth at 2.4 GHz. The radio transmitter is weak and always below 10mW equal to 10 dBm in total radiated power.

The Streamer complies with international standards concerning radio transmitters, electromagnetic compatibility and human exposure.

Due to the limited space available on the Streamer relevant approval markings can be found in this booklet.

### **USA and Canada**

This device contains a radio module with the following certification ID numbers:

FCC ID: U280MSTREAMER

IC: 1350B-OMSTREAMER

**Notice:**

The device complies with Part 15 of the FCC Rules and with Industry Canada's licence-exempt RSSs standards. Operation is subject to the following two conditions: (1) this device may not cause harmful interference, and (2) this device must accept any interference received, including interference that may cause undesired operation.

**Notice:**

Changes or modifications not expressly approved by the party responsible for compliance could void the user's authority to operate the equipment.

This Class B digital apparatus complies with Canadian ICES-003.

**NOTE:** This equipment has been tested and found to comply with the limits for a Class B digital device, pursuant to Part 15 of the FCC Rules.

These limits are designed to provide reasonable protection against harmful interference in a residential installation. This equipment generates uses and can radiate radio frequency energy and, if not installed and used in accordance with the instructions, may cause harmful interference to radio communications. However, there is no guarantee that interference will not occur in a particular installation.

If this equipment does cause harmful interference to radio or television reception, which can be determined by turning the equipment off and on, the user is encouraged to try to correct the interference by one or more of the following measures:

- Reorient or relocate the receiving antenna.
- Increase the separation between the equipment and receiver.
- Connect the equipment to an outlet on a circuit different from that to which the receiver is connected.
- Consult the manufacturer or an experienced radio/TV technician for help.

## **International warranty**

Your Streamer is covered by an international limited warranty issued by the manufacturer for a period of 12 months from the date of delivery. This limited warranty covers manufacturing and material defects in the device itself, but not in accessories such as e.g. batteries, cables, power supplies, etc. Problems arising from improper/incorrect handling or care, excessive use, accidents, repairs made by an unauthorised party, exposure to corrosive conditions, damage due to foreign objects entering the device or incorrect adjustments are NOT covered by the limited warranty and may void it. The above warranty does not affect any legal rights that you might have under applicable national legislation governing sale of consumer goods.

### **If you need service**

Take your Streamer to your hearing care professional, who may be able to sort out minor problems and adjustments immediately.



The manufacturer declares that this Streamer is in compliance with the essential requirements and other relevant provisions of Directive 2014/53/EU. Declaration of conformity is available at the manufacturer.

Oticon Medical Streamer XM is a trademark used by Oticon.



Manufactured by:  
Oticon A/S  
Kongebakken 9  
DK-2765 Smørum  
Denmark  
[www.oticon.global](http://www.oticon.global)



Waste from electronic  
equipment must be  
handled according to  
local regulations.



## Description of symbols used in this booklet



### Warnings

Text marked with a warning symbol must be read before using the device.



### Manufacturer

The device is produced by the manufacturer whose name and address are stated next to the symbol. Indicates the medical device manufacturer, as defined in EU Directives 90/385/EEC, 93/42/EEC and 98/79/EC.



### CE mark

The device complies with Medical Device Directive 93/42/EEC.



### Electronic waste (WEEE)

Recycle hearing aids, accessories or batteries according to local regulations. Hearing aid users can also return electronic waste to their hearing care professional for disposal. Electronic equipment covered by Directive 2012/19/EU on waste and electrical equipment (WEEE).



### Made for Apple badges

Indicates that the device is compatible with iPhone, iPad and iPod touch.



### Hearing loop

This logo incorporates the universal symbol for hearing assistance. The “T” signifies that a hearing loop is installed, and it is possible to switch to a T-coil programme.



### Indoor use









Indicates that the product is qualified for indoor use.



### Double insulation

Indicates that product power supply is double insulated. This means a very low risk of single fault failures, i.e. single fault failures cannot occur.

## Description of additional symbols used on labels

	<p><b>Keep dry</b> Indicates a medical device that needs to be protected from moisture.</p>
	<p><b>Caution symbol</b> Consult Instructions for Use for warnings and cautions.</p>
	<p><b>Regulatory Compliance Mark (RCM)</b> The device complies with electrical safety, EMC and radio spectrum requirements for devices supplied to the Australian or New Zealand market.</p>
	<p><b>Catalogue number</b> Indicates the manufacturer's catalogue number so that the medical device can be identified.</p>
	<p><b>Serial number</b> Indicates the manufacturer's serial number so that a specific medical device can be identified.</p>
<p>X,XV  XXXmA (ex. 5.0V, 200mA)</p>	<p><b>Power supply outlet</b> Indicates the rate at which power is sent from the outlet to your electrical device.</p>
	<p><b>Consult Instructions for Use</b> Indicates the need for the user to consult an Instructions for Use.</p>
	<p><b>Japan TELEC symbol</b> Indicates mark for certified radio equipment.</p>



**Oticon A/S**  
Kongebakken 9  
DK-2765 Smørum  
Denmark  
Tel.: +45 39 17 71 00  
[www.oticon.global](http://www.oticon.global)

202274UK / 2019.06.14



0000202274000001

**oticon** | Because  
MEDICAL sound matters